

Single Family



3812 SQFT



3 Beds



3 Baths



2 Car



0.16 Acre

PROPERTY DETAILS

Rarely available home in Sanctuary on the Park, featuring a landscaped, dog-friendly yard that backs to open space with access to Cherry Creek State Park trails. The yard includes perennial beds for attracting hummingbirds and butterflies, and mowing is covered by HOA dues. Enjoy outdoor views from the main level's covered deck or the walkout basement patio. The home is filled with natural light, has hardwood, bamboo and tile flooring and a spacious master suite with a five-piece bath and walk-in closet. The main level also includes a guest bedroom, office, and laundry. The lower level boasts a family room, workout area, and additional bedroom. The garage fits 2 cars with room for storage. Ideal for those seeking low maintenance and direct access to nature.



Lynn Wunsch
720-988-7187
lynnwunsch@gmail.com



Scan code
for more
property
details



6224 S Blackhawk Court, Centennial, CO 80111 — Main



TOTAL: 3158 sq. ft
BELOW GROUND: 1060 sq. ft, FLOOR 2: 2098 sq. ft
EXCLUDED AREAS: UTILITY: 403 sq. ft, COVERED PATIO: 311 sq. ft, GARAGE: 440 sq. ft,
PORCH: 69 sq. ft, BALCONY: 136 sq. ft
WALLS: 220 sq. ft

Floor Plan Created By V1photos.com, Measurements Deamed Highly Reliable But Not Guaranteed.



Disclaimer: Sizes and Dimensions are Approximate, Actual May Vary.



Lynn Wunsch
720-988-7187
lynnwunsch@gmail.com



Scan code
for more
property
details



6224 S Blackhawk Court, Centennial, CO 80111 — Lower Level

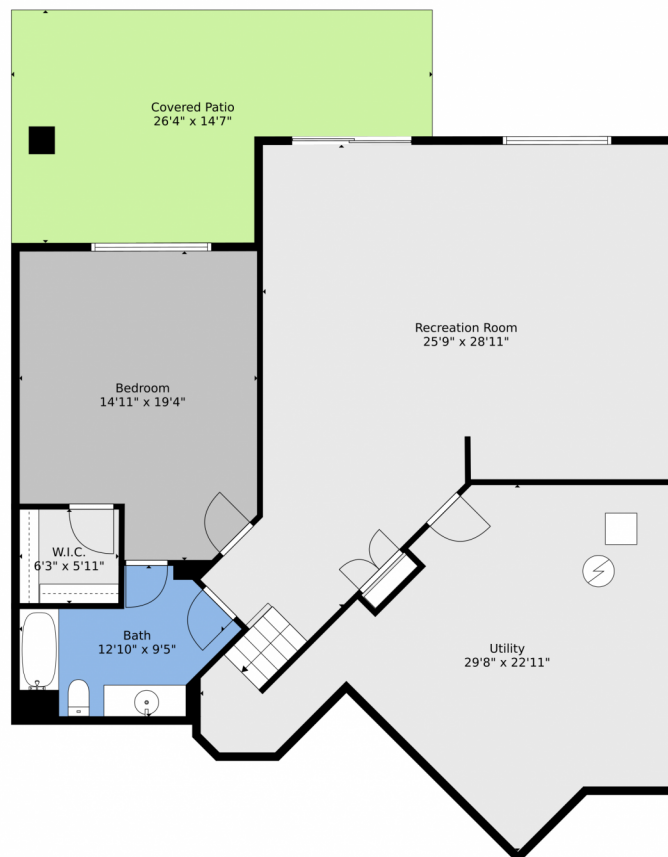

TOTAL: 3158 sq. ft
BELOW GROUND: 1060 sq. ft, FLOOR 2: 2098 sq. ft
EXCLUDED AREAS: UTILITY: 403 sq. ft, COVERED PATIO: 311 sq. ft, GARAGE: 440 sq. ft,
PORCH: 69 sq. ft, BALCONY: 136 sq. ft
WALLS: 220 sq. ft

Floor Plan Created By V1photos.com, Measurements Deamed Highly Reliable But Not Guaranteed.



Disclaimer: Sizes and Dimensions are Approximate, Actual May Vary.



Lynn Wunsch
720-988-7187
lynnwunsch@gmail.com



Scan code
for more
property
details

