

Instant equity with Exterior/Interior paint & Carpet!



Single Family



3800 SQFT



3 Beds



3/1 Baths



3 Car



4 Acre

PROPERTY DETAILS

Ranch walkout on 4 acres with stunning mountain views and great equity potential! Built in 2013, this ranch-style home features solid 2x6 construction. Inside, enjoy a chef's kitchen with a gas cooktop, double ovens, and ample counter space, flowing into an open-concept great room and dining area. It has 3 bedrooms, 3.5 baths, and a spacious 1,080 sq ft garage. The walkout basement is perfect for entertaining, equipped with a bar and space for multiple TVs and a pool table. A flex room currently serves as a gym but can be repurposed. Priced at \$900,000, this home allows for personal updates and offers significant equity potential, as nearby homes are selling for \$1.385M to \$1.4M. Don't miss out!



Jodi Rae Randa
720-244-1796
jodi@jodiranda.com
<https://JodiRanda.com>



Scan code
for more
property
details



4959 Rocky View Point, Castle Rock, CO 80108 – All Levels

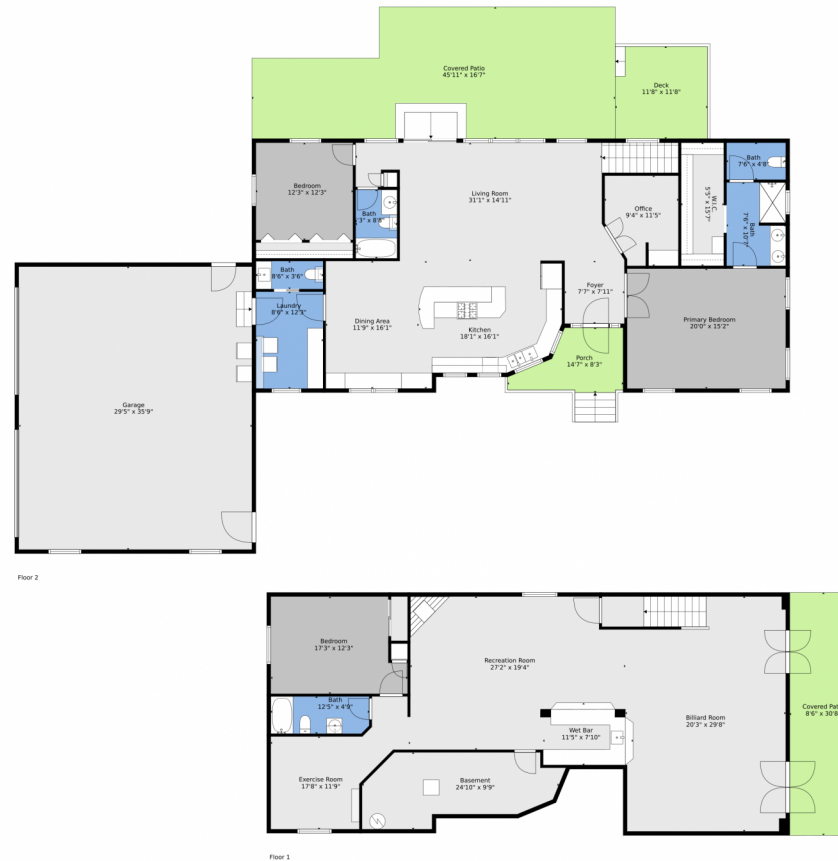

TOTAL: 3586 sq. ft
BELOW GROUND: 1620 sq. ft, FLOOR 2: 1966 sq. ft
EXCLUDED AREAS: BASEMENT: 193 sq. ft, COVERED PATIO: 922 sq. ft, GARAGE: 1053 sq. ft,
DECK: 136 sq. ft, PORCH: 104 sq. ft, WALLS: 265 sq. ft

Floor Plan Created By V1photos.com, Measurements Deamed Highly Reliable But Not Guaranteed.



Disclaimer: Sizes and Dimensions are Approximate, Actual May Vary.



Jodi Rae Randa
720-244-1796
jodi@jodiranda.com
<https://JodiRanda.com>



Scan code
for more
property
details

